

1 Introduction

Please confirm

- 1 The device appearance is not damaged.
- 2 Confirm all the accessories according to the checklist.

Checklist:

- ◆ Sub Door Station
- ◆ Quick start Guide
- ◆ Screw Package

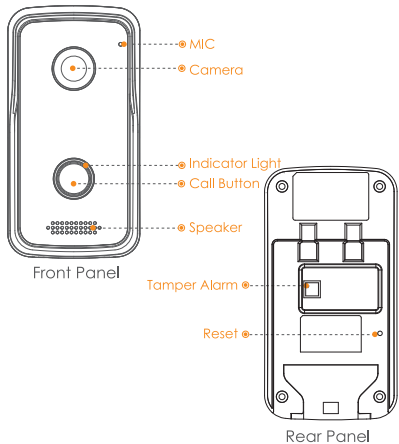

2 Installation

Configure the device **first**,
and then install it.

- 1 Drill screw holes on the mounting surface according to those on the mounting plate.
- 2 Put the expansion bolts in the screw holes.
- 3 Attach the mounting plate to the mounting surface with the screws.
- 4 Fix the sub door station on the mounting plate with the screw.
- 5 Put silicone sealant between the sub door station and the mounting surface.

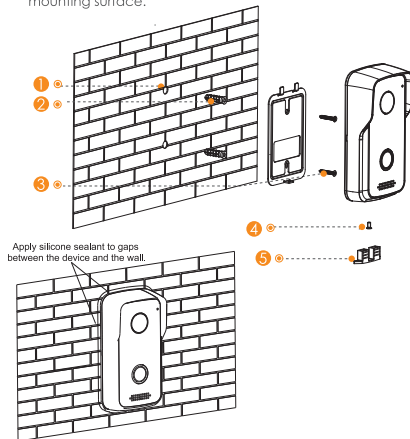

Поставщик систем безопасности TELECAMERA.RU

3 Safeguards and Warnings

The following description is the correct application method of the device. Please read them carefully before use to prevent danger or property loss.

Operating Requirement

- ◆ Do not place and install the device in an area exposed to direct sunlight or near heat generating device.
- ◆ Do not install the device in a humid, dusty or fuliginous area.
- ◆ Please keep its horizontal installation, or install it at stable places, and prevent it from falling.
- ◆ Do not drip or splash liquids onto the device; don't put on the device anything filled with liquids, in order to prevent liquids from flowing into the device.
- ◆ Please install the device at well-ventilated places; don't block its ventilation opening.
- ◆ Use the device only within rated input and output range.
- ◆ Do not dismantle the device arbitrarily.
- ◆ Please transport, use and store the device within allowed humidity and temperature range.

About the Manual

- ◆ The Manual is for reference only, and the actual product shall prevail.
- ◆ All the designs and software are subject to change without prior written notice.
- ◆ All trademarks, registered trademarks and the company names in the manual are the properties of their respective owners.
- ◆ Please visit our website, contact the supplier or customer service if there is any problem occurred when using the device.
- ◆ If there is any uncertainty or controversy, please refer to our final explanation.

4 FAQ

- ▶ **The device is not operating normally.**
Please reset the device and configure it again.

- ▶ **How to reset the device.**
Press and hold the reset button for 10 s.

- ▶ **Device is offline.**

If the device indicator light keeps flashing with blue light, then it is offline. You need to check your network connection, and if the network connection is normal, you can reset and configure the device again.

Quick Start Guide

Sub Door Station

V1.0.0