

Video Alarm Control Panel

Quick Start Guide

V1.0.0

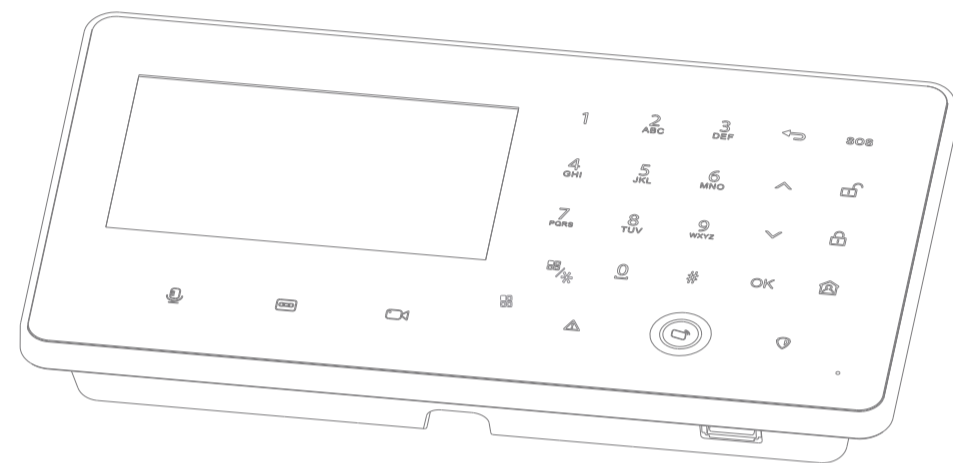

ARC5402A-W doesn't support 2G network.

1.2.51.32.14372-001

Important Safeguards and Warnings

Please read the following safeguards and warnings carefully before using the product in order to avoid damages losses and body injuries. After reading, please well keep this user's manual.

Note:

- Please change user default password after being armed.
- Do not install the device at position exposed to sunlight or in high temperature. Temperature rise in device may cause fire.
- Do not expose the device to lampblack, steam or dust. Otherwise it may cause fire or electric shock.
- The device must be installed on solid and flat surface in order to guarantee safety under load and earthquake. Otherwise, it may cause device to fall off or turnover.
- Do not drop or splash liquids onto the device, and do not place container with full liquid on the device to prevent liquid spilling from entering the device.
- Do not block air vent of the device or ventilation around the device. Otherwise, temperature in device will rise and may cause fire.
- Use the device only within rated input and output range.
- Do not disassemble the device without professional instruction.
- Please transport, use and store the product under appropriate temperature and humidity.

Warning:

- Please use battery properly to avoid fire, explosion and other dangers.
- Please replace used battery with battery of the same type.
- Do not use power line other than the one specified. Please use it properly within rated range. Otherwise, it may cause fire or electric shock.
- Please use power supply matching SELV requirements, and IEC60950-1 Limited Power Source. Power supply shall follow requirements on device label.
- For I-type structure product, connect it to power supply plug with GND protection.
- If you use power plug or appliance coupler as disconnecting device, please maintain the disconnecting device available to be operated all the time.

Special Announcement

- This manual is for reference only, subjected to the actual product.
- All the designs, software and instructions here are subject to change without prior written notice.
- All damaged and losses caused by operation not following instructions in this manual, are borne by the user.
- All trademarks and registered trademarks are the properties of their respective owners.
- If there is any uncertainty or controversy, please refer to the final explanation of us.
- Please visit our website for more information.

Checklist

Please check if the device appearance has obvious damage and if accessories are complete.

Panel*1	Battery*1	Bracket*1	Screw bag*1	Metal film resistor*1
Flat cable*2	Ethernet cable*1	Manual*1		

Typical Network

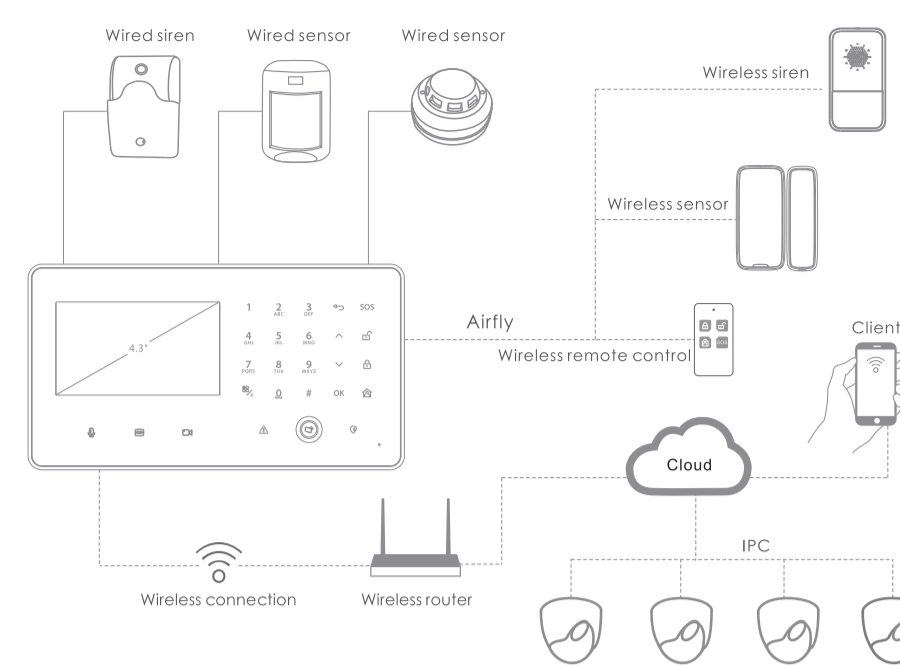

Panel Component

- 4.3 inch LCD, show interface and operation process and preview channel.
- : Click it to record audio, up to 30s each time. Save in system.
- : Click it to play the most recent record.
- : Click it to preview this channel. Click ^ or v , to switch channel.
- 0-9: Enter number, page up/down.
- A-Z: A-Z: Enter letter.
- *: Return to homepage.
- # : Enter ". "
- In homepage, click 1 to customize arm. Click 2 to view failure info. Click 3 to view zone warning info.
- : Return to previous menu, delete info, exit record playback/video preview.
- : Move up.
- : Move down.
- : Confirm
- : Long click it for 3s to alarm.
- : Disarm
- : Away arm
- : Stay arm

- Password: modify user password, support 4-8 digits of number.
- Info: view log info and version, SN.
- Time: Set device time, time format and DST.
- SD Card: View SD card capacity or format.
- Network: Set network connection, support wired, WIFI, 2G, P2P and etc.
- Other: Set entry delay, exit/screen off time, volume and etc.
- Alarm Center: Set alarm center info, support 2 groups of alarm center.

Wired Setting

The device supports wired setting.

- In homepage, click ^ or v , select System, click OK.
- Click ^ or v , select Net, click OK.
- Click ^ or v , select Wired, click OK.
- Click ^ or v , select address, click > to delete old info, enter new address via number keys. Repeat this step to modify address, subnet mask, gateway, DNS1 and DNS2.

Note: If you check DHCP, when the system auto get IP address, you do not need to enter IP.

- Click ^ or v , select Save, and click OK to save.

WIFI Setting

The device supports WIFI.

- In homepage, click ^ or v , select System, click OK.
- Click ^ or v , select Net, click OK.
- Click ^ or v , select WIFI, click OK.

- : When sensor is offline or main power is down, indicator turns on.
- : For signed up card, you can swipe the card to away arm and disarm. When there is an alarm, indicator turns red and NO.
- : During arming, blue indicator NO.
- : Audio capture.

PWR: 12V power input	GND: Ground
AUX: 12V AUX power output	LAN: Network
Z1/Z2: Local 2-ch zone input	BELL: Active siren output
RING-O/TIP-O: Tel input	RING-I/TIP-I: Phone
NO/COM: Local 1-ch relay alarm output	485-A/485-B: 485 device

- : Insert two ends of cable into these holes to reset device.
- : Vandal-proof switch
- : SIM card slot

Battery slot, install 1900mAh battery. When 12V power has outage, it provides emergency power supply for device. When re-connect to a 12V power, the device will reboot in 3 minutes to ensure that all functions can normally run.

Note: There is SD card slot on the left, see Chapter of SD Card Installation.

At side there is USB port, connect to storage device and used as backup.

Slot of cable, pull cable out from here.

Installation Process

SD Card Installation

- Open battery cover, take out battery.
 - Push SD card into slot in accordance with direction of arrow.
- Note: Please make sure you unplug the device from power before you install or uninstall SD card. To take out SD card, push it inward a bit, and use a tool to take it out.

SIM Card Installation

- Push slot cover toward cable port, flip it up to open slot.
 - Insert SIM card into slot in accordance with direction of arrow.
 - Put back slot cover, and push it forward to fix SIM card.
- Note: ARC5402A-W doesn't support 2G network.

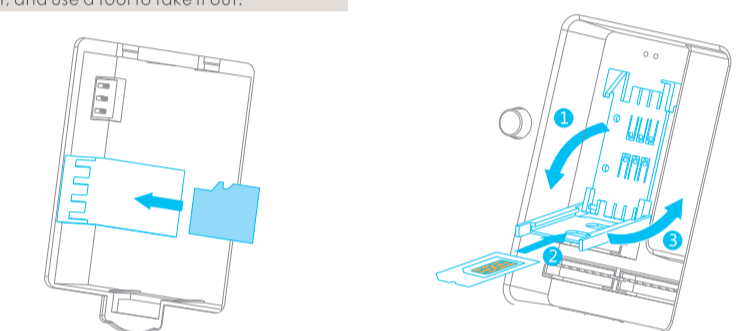

Battery Installation

- Place battery into battery box in accordance with direction of arrow.
- Close cover in accordance with direction of arrow.

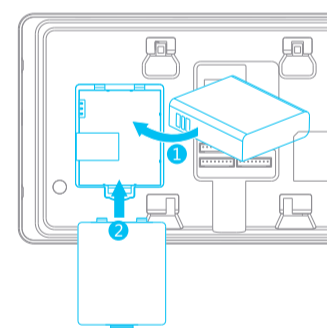

86 Box Installation

- Lock installation bracket at 86 box fixing hole with screw A as to fix bracket on wall.
- Hang the device on hook of installation bracket in accordance with direction of arrow.

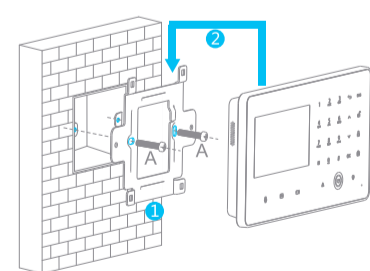

Cable Installation

- Insert cable into corresponding pin header plug.
- Pull all cables out together from slot.

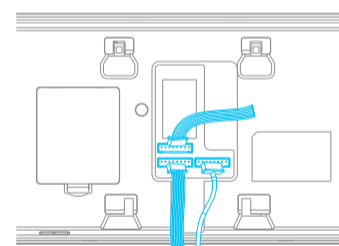

Non-86 Box Installation

- Open hole on wall in accordance with position of screw B of bracket, and embed expansion bolt.
- Fix installation bracket directly on wall with screw B.
- Hang the device on hook of installation bracket in accordance with direction of arrow.

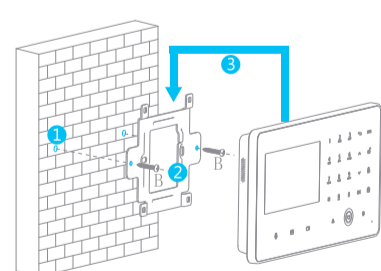

Password Setting

For security reason, you can change password at first time login, or change password in Setting->Set Password.

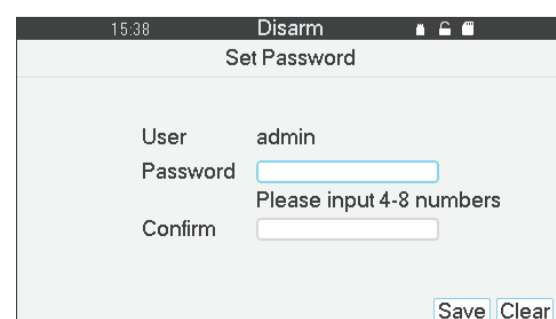

- Device boots up, it shows Set Password interface. Select field with ^ or v . Enter password via number key, and confirm password.
- Note: In case of miss-typing, you can click ^ or v , and select reset to clear content you entered.
- Click ^ or v , select Next and click OK to enter homepage.

Homepage

Connect device to power, device boots up and shows "welcome" progress bar. When the process complete, you can see homepage.



- : Strength of SIM card, and represent that SIM card has been installed.
- : WIFI symbol, represent WIFI connection enabled.
- : System disarm status.
- The device support battery as power. When both main power and battery exist but power is not full, it will charge the battery. The interface shows battery icon and power percentage.
- : USB symbol, represent a USB has been inserted.
- : System is disarmed. Armed system shows .
- : SD card symbol, represent a SD card has been installed.
- 18 28 | 8:28 : Current system time.
- 2016-12-26 星期一 : Current system date.
- : means current system has unread message, please click for playback.
- : Search, view and backup event.
- Include the following functions:
 - Zone: Set zone.
 - RFID: Add RFID card, arm/disarm by card.
 - Mode: Arm mode of zone, unified arming.
 - Link: Set linkage when alarm if triggered.
 - Camera: Add IPC and set linkage for motion detection and video tampering.
 - Other: Set SOS, panel outage, chassis intrusion and other alarm uploading.
 - Wireless enrollment: Enrollment between wireless terminal and device.

- Click ^ or v , select , click OK, to switch to , enable WIFI.
- Click ^ or v , select Search, click OK to search and show available WIFI. Click ^ or v , select WIFI, click OK and enter password to connect. If the interface shows WIFI info, it means connection is successful, otherwise please try again.

Note: Pair function is used for device to connect WIFI in the same environment with the mobile phone. When you enter WIFI password in the APP, select Pair on device to connect to the WIFI, please see Mobile Phone APP Manual. Input refers to Appendix 2.

P2P Setting

Enable P2P function, open mobile phone APP, directly input the SN or scan QR code to get SN, save setting and then you can arm/disarm on APP to manage more than one device.

Note: When you use this function, you must connect the device to WIFI.

- In homepage, click ^ or v , select System, click OK.
- Click ^ or v , select Net, click OK.
- Click ^ or v , select P2P, click OK.
- Click ^ or v , select , click OK, switch to , to enable P2P function. \$Status changes to "Online" . Now you can scan QR code with APP or directly enter SN to add device and access management device, please refer to mobile phone APP manual.

Wireless Enrollment

It is used to add/delete wireless sensor, wireless siren, wireless remote control and etc.

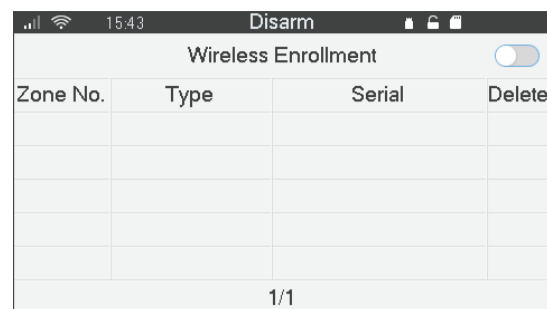

1. In homepage, click ^ or v, select Setting, click OK.

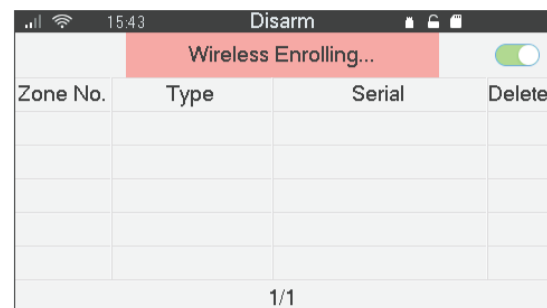

2. Click ^ or v, select Wireless Enrollment, click OK.

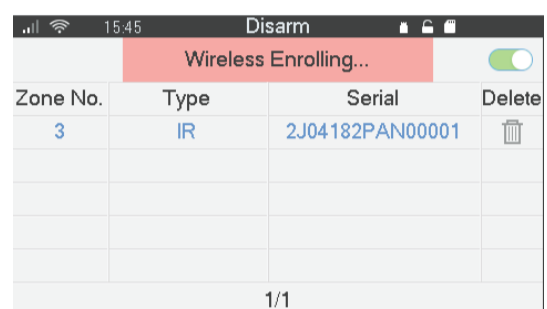

3. Click ^ or v, select , click OK to enable wireless enrollment function, icon is .

4. Enroll in accordance with wireless device below, please refer to Appendix 1.

Add Camera

It is used to add/delete remote camera.

- Note:**
- Screen saver: Screen saver turns on if no operation has been performed for this length of time. You can wake screen up by clicking any key.
 - Volume: Adjust buzzer, siren.
 - Tone: Enable or disable touch button.

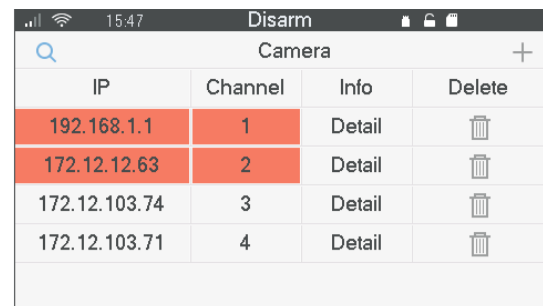

1. In homepage, click ^ or v, select Setting, click OK.

2. Click ^ or v, select Camera, click OK.

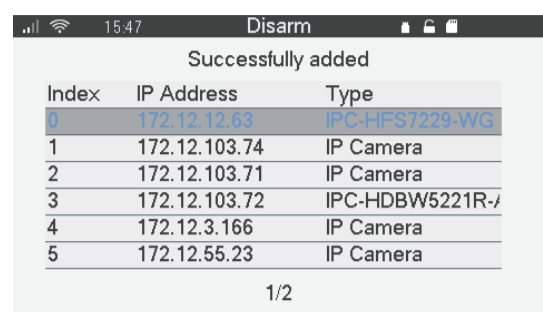

3. Click ^ or v, select , click OK to search all cameras in the same segment.

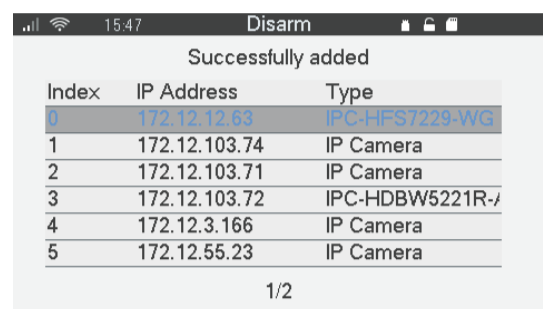

4. Click ^ or v, select camera, click OK to add this camera.

Note: You can add up to 4 cameras.

Add RFID Card

After RFID card is added, you can use this card to away arm and disarm.



1. In homepage, click ^ or v, select Setting, click OK.

2. Click ^ or v, select RFID, click OK.

3. Click ^ or v, select +, enter card interface.



4. Swipe RFID card. It shows ID as being identified. Click ^ or v, to select name field, click OK and enter card name.

5. Click ^ or v, select Save, click OK.

Zone Setting

You can set zone name, link parameter when it alarms.

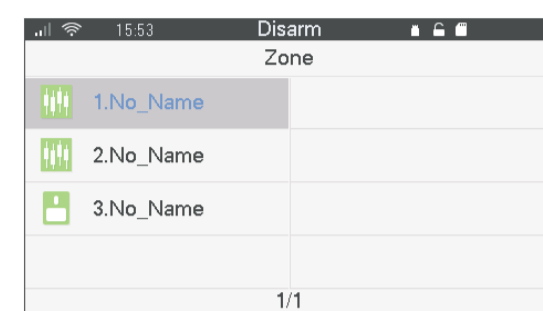

1. In homepage, click ^ or v, select Setting, click OK.

2. Click ^ or v, select Zone, click OK.

3. Click ^ or v, select zone, click OK to enter zone setup page.

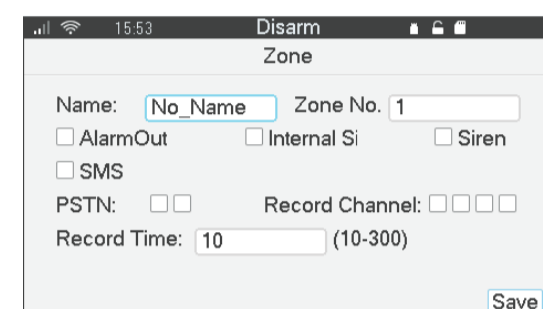

4. Click ^ or v, select name field, click OK. Enter zone name, click OK.

Note: Input refers to Appendix 1.

5. Click ^ or v, select other parameter box, click OK. Click OK to save.

Note:

- Alarm center boxes are alarm center 1 and alarm center 2 in sequence.
- Record channel box are channel 1-4 in sequence.
- After you select record time field, directly enter number to input.

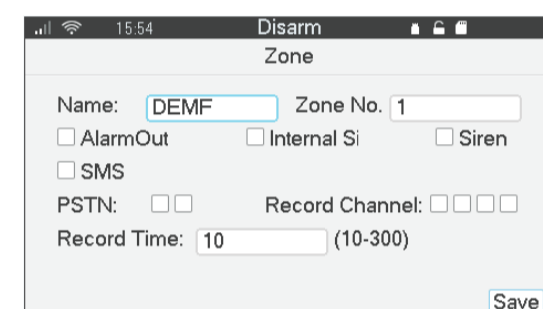

6. Click ^ or v, select Save, click OK.

Mode

The system provides stay arm, away arm, and custom arm, and user shall add designated zones into corresponding mode in order to disarm.

- Stay arm: recommend to add zones surrounding your home into this rule. When you are at home, enable stay arm.
- Away arm: recommend to add all zones into this mode. When you are away, enable away arm.
- Custom arm: recommend to add necessary zones into this rule. When you need this customized arm, enable it.

The following examples are based on "three zones are added into stay arm".

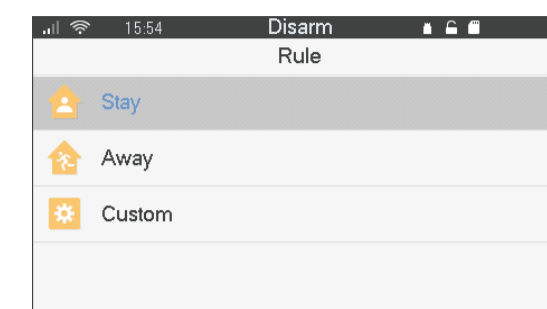

1. In homepage, click ^ or v, select Setting, click OK.

2. Click ^ or v, select mode, click OK.



3. Click ^ or v, select stay arm, click OK to enter zone selection.

4. Click ^ or v, click OK to select zone.

Note:

- You may repeat this step to select more zones.
- A zone can be added into different modes.

5. Click ^ or v, select Save, click OK.

Zone Delay Setting

The device provides enter delay and exit delay, valid for away arm only.

- Exit delay: when exit delay is set, when you enable away arm, a countdown starts and you can leave the zone within this countdown without triggering alarm.
- Enter delay: when entry delay is set, and someone enters away armed zone, you can disarm within the set enter delay period without triggering alarm.

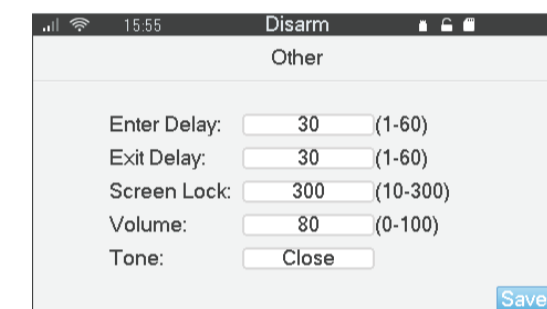

1. In homepage, click ^ or v to select System, click OK.

2. Click ^ or v, select Other, click OK.

3. Click ^ or v, select parameter field, click \rightarrow to delete old information and enter new value via number key.

4. Click ^ or v, select Save, click OK.

Initial

It restores the device to initial setting.



1. In homepage, Click ^ or v, select System, click OK.

2. Click ^ or v, select Initial, click OK.

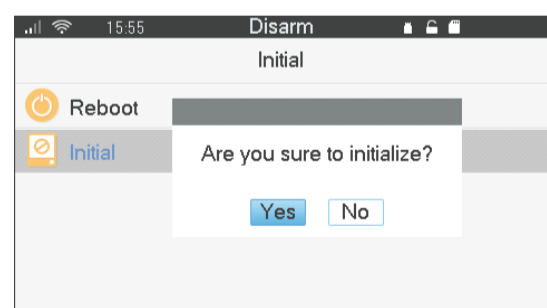

3. Click ^ or v, select Initial, click OK. Confirmation box pops up.

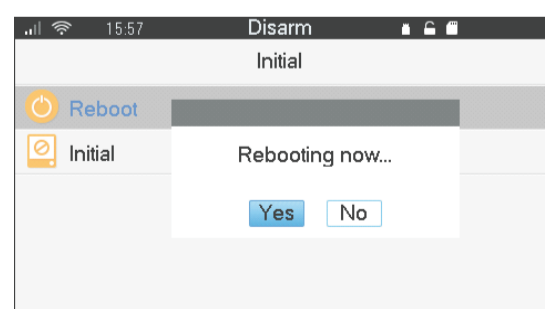

4. Click ^ or v, select Yes, click OK. It is rebooting, then it goes to password change interface.

System Status

On screen it shows Disarm bar at top, meaning that the system is disarmed, and you can arm now.

On screen it shows Arm bar at top, meaning that the system is armed, and you must disarm before you can arm again.

Arm/Disarm Shortcut

The system provides shortcut for stay arm, away arm, custom arm, disarm and etc.

Note: Before you arm, please make sure the zone you intend to arm has been added into mode of arming.

Stay Arm

- Click , password box pops up.
- Enter password via number key.
- Click OK, with a beep, LCD shows Arm at the top, zones within stay arm mode enter arming.

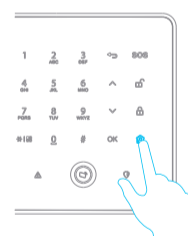

Away Arm

- Click , password box pops up.
- Enter password via number key.
- Click OK, with a beep, if enters exit countdown, LCD shows Arm at the top, zones within away arm mode enter arming status and exit zone before countdown ends, which will not trigger alarm.

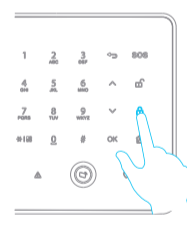

Custom Arm

- Click , password box pops up.
- Enter password via number key.
- Click OK, with a beep, LCD shows Arm at the top, zones within custom arm mode enter arming.



Disarm

- Click , password box pops up.
- Enter password via number key.
- Click OK, system beeps twice, LCS shows Disarm at the top to cancel previous arming and all zones disarm.

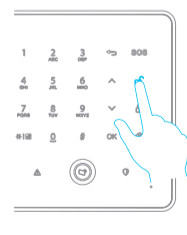

Disarm via Card

The system supports to swipe card in order to disarm, but valid for zones in mode of away arm only.

Note: Before arming, make sure all designated zones are in mode of away zone.

Arm

In disarming status, swipe card, system beeps, and enters exit countdown. LCD shows Arm at the top, zones within away arm mode enter arming status and exit zone before countdown ends, which will not trigger alarm.

Disarm

In arming status, swipe card, system beeps twice, LCS shows Disarm at the top to cancel previous arming and all zones disarm.



Remote Control Disarm

The system supports disarm via remote control, so you can perform stay arm, away arm, disarm and sos remotely.

Note: Before you arm, make sure you have added zones into mode of arming.

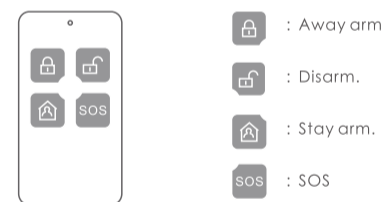

Mobile Phone APP

The device supports to arm/disarm on mobile phone APP, please see manual of mobile phone APP.

Duress Password

The device supports duress password, and when you enter duress password, the system will duress alarm. Duress password links to SMS and alarm info on PSTN by default, and it will not create log. A duress password is to add "1" to the last number of user password, and if the last digit is "9", then enter "0" as the last digit. For example, a user password is "123456", so its corresponding duress password is "123457". A user password is "123459", then its corresponding duress password is "123450".

Appendix 1

Wireless Sensor/Siren Enrollment

Power up sensor/siren, and let the system auto pair in the network. If LCD shows the sensor/siren, it means pairing is successful, otherwise pairing failed. If failed, you can repeat powering up device until pair succeeds. You also can dial up case vandal-proof switch on sensor/siren to manually pair.

Note:

- Wireless sensor channel no. start from 3.
- Wireless siren channel no. start from 44.

For example, wireless passive IR intrusion sensor has its vandal proof switch on the right, see the figure.

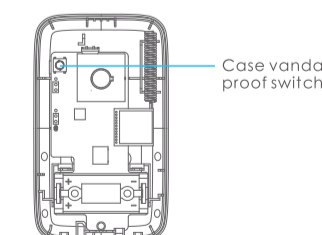

Wireless Remote Control Pair

Click any key, if LCD shows remote control info, pairing succeeded. Otherwise, pairing failed, please try again.

Wireless SOS Pair

Install battery, after red indicator flashes, if indicator is OFF and LCD shows SOS info, pairing succeeds. If red indicator slowly flashes three times, pairing failed, please try again.

Note:

Wireless remote control and wireless SOS key channels start from 35.

Appendix 2 Input

The system provides input of letter and number, and switch of input method is required.

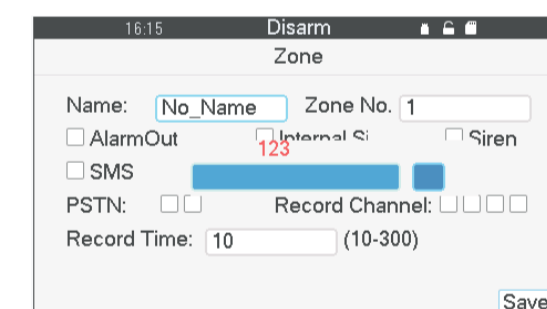

1. In zone setup page, click ^ or v, select name field, click OK to pop up input.

2. Enter number via number key.

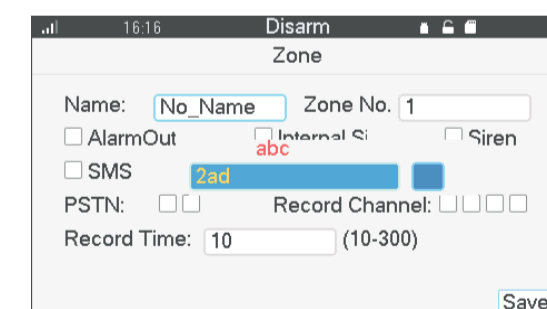

3. Click ∇ , to switch input from lower case to upper case. When you click a number with letter printed on it, the input loops three letters printed on it for you to click. Then you can click other number key or click ^ to input upper case of letter on the current key.

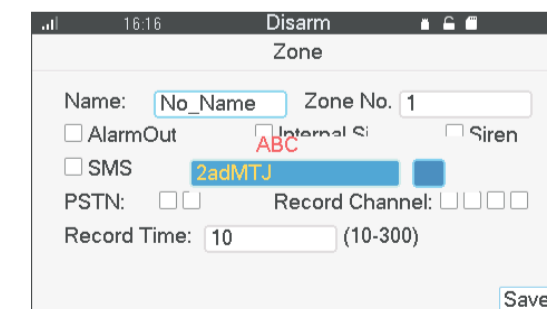

4. Click ∇ , to switch input from upper case to lower case.

5. Click OK to enter input into the field.

Note:

- This manual is for reference only. Slight difference may be found in user interface.
- All the designs and software here are subject to change without prior written notice.
- All trademarks and registered trademarks are the properties of their respective owners.
- If there is any uncertainty or controversy, please refer to the final explanation of us.
- Please visit our website or contact your local service engineer for more information.