

DHI-VTO9631Q

IP Face Recognition Apartment Door Station

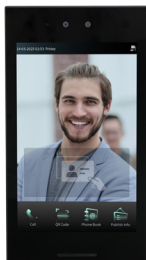

Scene

Ideal for use in multiple scenes such as apartment, office buildings, compound buildings, communities, etc.

Technical Specification

System

Main Processor	Embedded Processor
Operating System	Embedded Linux OS
Interoperability	ONVIF; CGI
Network Protocol	RTP; SIP; DNS; SSH; RTSP; RTMP; FTP; HTTP/HTTPS; ONVIF

Basic

Screen Type	Capacitive Touchscreen
Display Screen	10.1-inch display screen
Screen Resolution	800 (H) × 1280 (V)
Camera	1/2.8" 2 MP CMOS high-definition, low illumination, dual cameras
Field of View	H: 65°; V: 40°; D: 73°
WDR	DWDR
Noise Reduction	3D NR
Video Compression	H.264; H.265
Video Resolution	Main stream: 720P/D1/WVGA; Sub stream: 1080P/720P/D1/WVGA/CIF/QVGA
Video Frame Rate	PAL: 25 fps; NTSC: 30 fps
Video Bit Rate	256 kbps–4,096 kbps
Light Compensation	Auto IR
Audio Compression	G.711a; G.711u; PCM
Audio Input	1 channel
Audio Output	Includes the built-in speaker and can be connected to active external speakers.

- 10.1" LCD with a resolution of 800 × 1280.
- 2 MP HD dual-lens camera.
- Supports 200,000 users, 100,000 faces, and 100,000 cards.
- Recognizes faces 0.3 m to 1.5 m away (0.98 ft-4.92 ft) at an accuracy of 99.9%, and compares 1 face with N faces at the speed of 0.2 seconds/person.
- Liveness detection is used to detect spoof attempt, such as using a photo or video to gain access.
- Displays text and image information released by the management center.
- Offers multiple types of alarms such as duress, tamper, emergency and alarms from door detectors.
- Supports leaving audio and video messages when no one responds through the VTH. (An SD card is required.)
- Supports multiple unlock methods including password, IC card and face, and unlocks remotely.
- Unlocks the door through the VTH, management center and app.
- Outputs 1-channel 12 VDC and 700 mA to supply power for the access control module or card reader.
- IP65 rated (Silicone sealant is required for the flush mount plate.)



Audio Mode	Two-way audio
Audio Enhancement	Echo suppression/digital noise reduction
Audio Bit Rate	16 kHz, 16 bit

Function

Communication Mode	Full digital
Verification Method	Remote; Face Recognition; Password; Card
Auto Snapshot	Yes
Information Release	Receive and view text information released by the management center.
Elevator Control	Residents and visitors can call elevators. Permissions can also be granted to access floors through access control.
Leave Videos	Yes (SD card inserted in VTO is needed)
Storage	Supports Micro SD card (up to 128 GB)
Web Configuration	Yes
Auto Registration	Yes

RFID

Card Type	IC card
Modulation Type	ASK

ASGB9 Series | DHI-ASGB913S-L

Frequency Range	13.56 MHz
Max. Transmission Power	42 dBuA/m @10 m

Performance

Card Reading Distance	0 cm–4 cm (IC card)
Face Recognition Height Range	1.2 m–2.0 m (3.94 ft–6.56 ft)
Face Recognition Distance	0.3 m–1.5 m (0.98 ft–4.92 ft)
Face Recognition Accuracy	99.9%
Face Recognition Time	0.2 s
Casing Material	Tempered glass; Aluminum alloy

Capacity

Card Capacity	100,000
Face Image Capacity	100,000
User Capacity	200,000

Port

RS-485	1 channel
Wiegand	1 channel
Alarm Input	2 channels
Alarm Output	2 channels
Power Output	1 port (12 V, 700 mA)
Exit Button	1 channel
Door Status Detection	1 channel
Lock Control	1 channel, open by default
Network Port	1 × 10 Mbps/100 Mbps Ethernet port

Alarm

Tamper Alarm	Yes
--------------	-----

General

Appearance Color	Black
Power Supply	12 VDC, 3 A
Power Adapter	Optional
Installation	Surface Mount; Flush Mount
Certifications	CE
Accessory	Power supply (optional); Flush mount box (optional); Surface Mounted (optional)
Product Dimensions	294.9 mm × 162.5 mm × 25.0 mm (11.61" × 6.40" × 0.98") (H × W × D)
Protection	IP65 rated (Silicone sealant is required.)
Operating Temperature	–30 °C to +60 °C (–22 °F to +140 °F)
Operating Humidity	0%–90% (RH), non-condensing
Operating Environment	Outdoor
Operating Altitude	0 m–1,300 m (0 ft–4,265.09 ft)

Power Consumption	≤ 8 W (standby), ≤ 10 W (working). These two values of power consumption do not contain the output power.
Gross Weight	1.61 kg (3.55 lb)
Storage Temperature	–20 °C to +70 °C (–4 °F to +158 °F)
Storage Humidity	30%–75%

Ordering Information

Type	Model	Description
Door Station	DHI-VT09631Q	IP Face Recognition Apartment Door Station
Accessories	VTM95	Surface Mounted Box
	VTM96	Flush Mounted Box

Installation

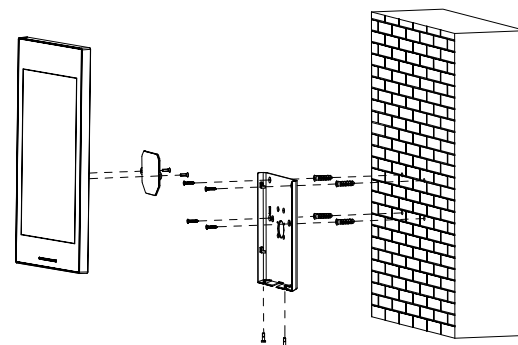
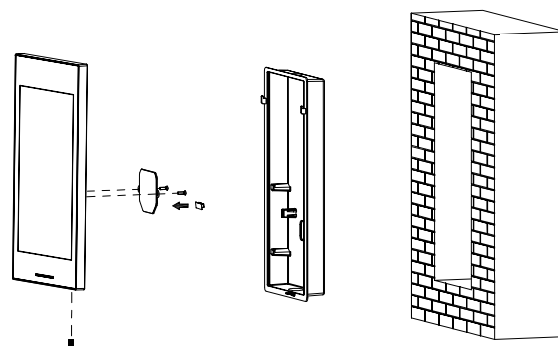

ASGB9 Series | DHI-ASGB913S-L

Dimensions (mm[inch])

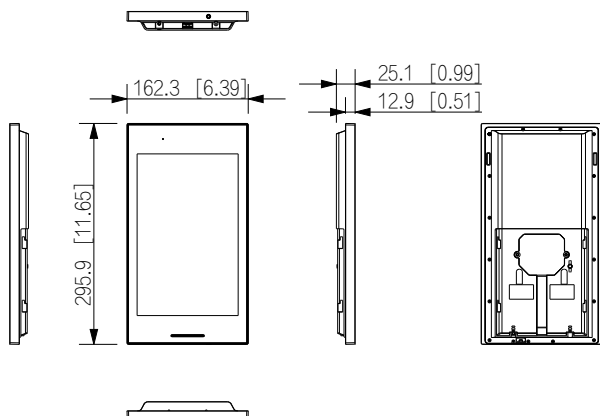

Application

